

- 1 MATCH EXIST CURB.
- 2 EXIST CURB RAMP TO BE REMAIN.
- 3 PROPOSED 5' WIDE CURB RAMP.
- 4 REMOVE EXISTING THERMOPLASTIC PAVEMENT MARKING.
- 5 PROPOSED THERMOPLASTIC PAVEMENT MARKING.
- 6 EXISTING PEDESTRIAN SIGNAL POLE TO BE REMOVED.
- 7 EXISTING TRAFFIC SIGNAL POLE TO REMAIN. ROTATE PEDESTRIAN SIGNAL HEAD TOWARDS PROPOSED CURB RAMPS.
- 8 EXISTING TRAFFIC SIGN TO REMAIN
- 9 REMOVE EXISTING TRAFFIC SIGN
- 10 REMOVE EXISTING SIDEWALK OR CURB RAMP (SEE PREVIOUS SHEET)
- 11 18" CLEARANCE TO ALLOW DRAINAGE TO EXISTING INLET.
- 12 EXISTING INLET TO REMAIN
- 13 PROPOSED REFLECTIVE YELLOW CURB MARKING.
- 14 MATCH EXISTING SIDEWALK.
- 15 PROPOSED 2' WIDE MOUNTABLE SLOTTED CURB, PAINTED REFLECTIVE YELLOW
- 16 PROPOSED 6" REINFORCED MEDIAN ISLAND WITH #3 BARS AT 18"
- 17 ADJUST EXISTING WATER VALVE TO TOP OF CONCRETE ISLAND.
- 18 REPLACE PAVEMENT USING HIGH EARLY STRENGTH CONCRETE-CofH Detail 02951-02
- 19 REMOVE & REPLACE EXISTING CURB.
- 20 SAW-CUT EXISTING CONCRETE PAVEMENT

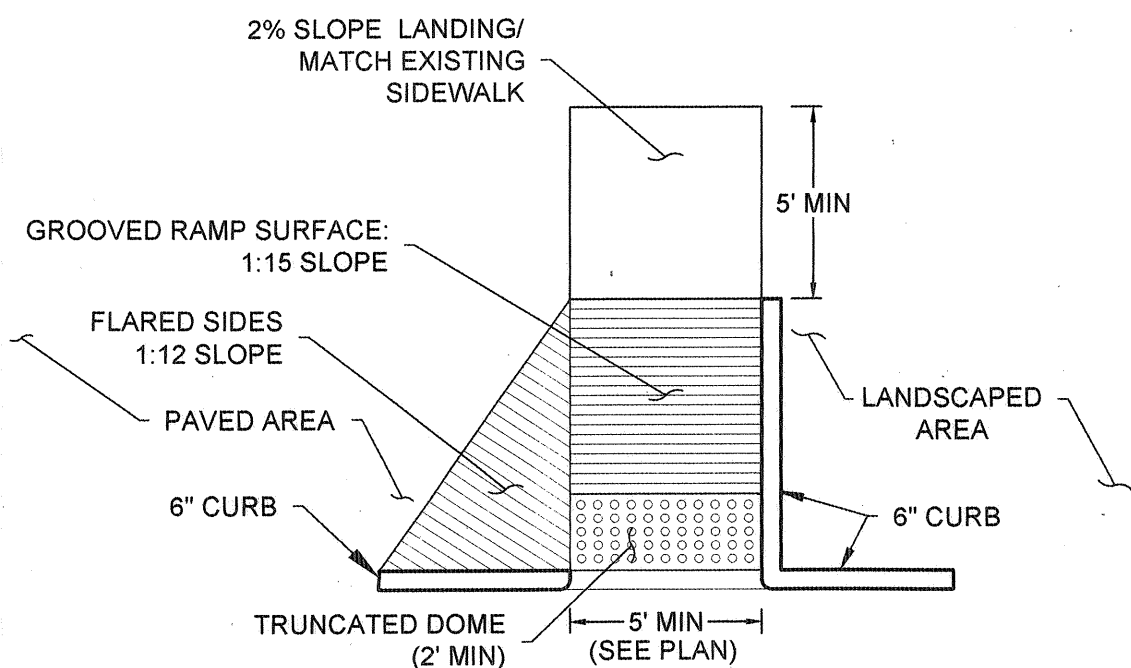

TYPICAL RAMP DETAIL

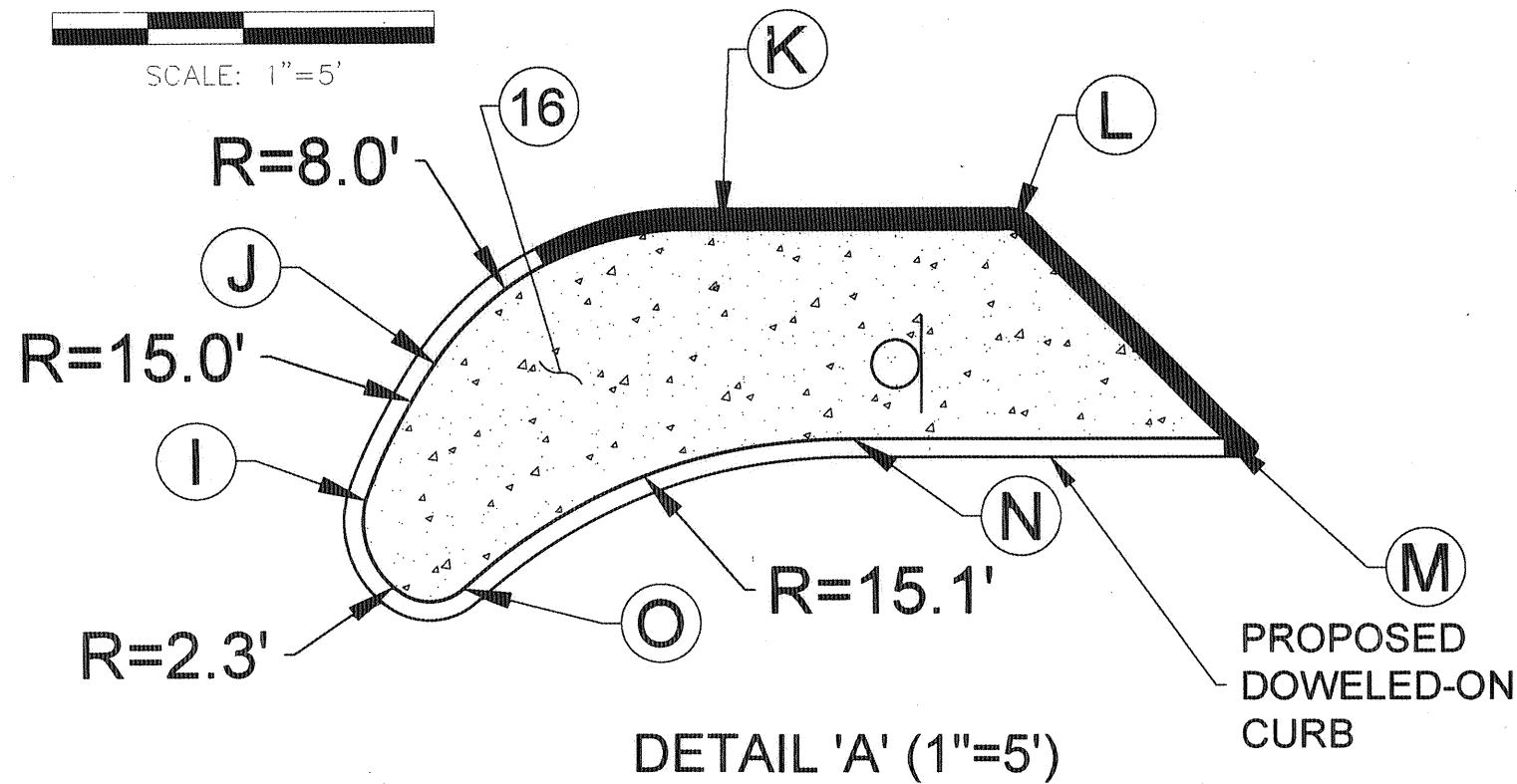
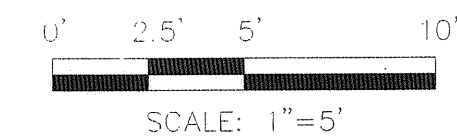
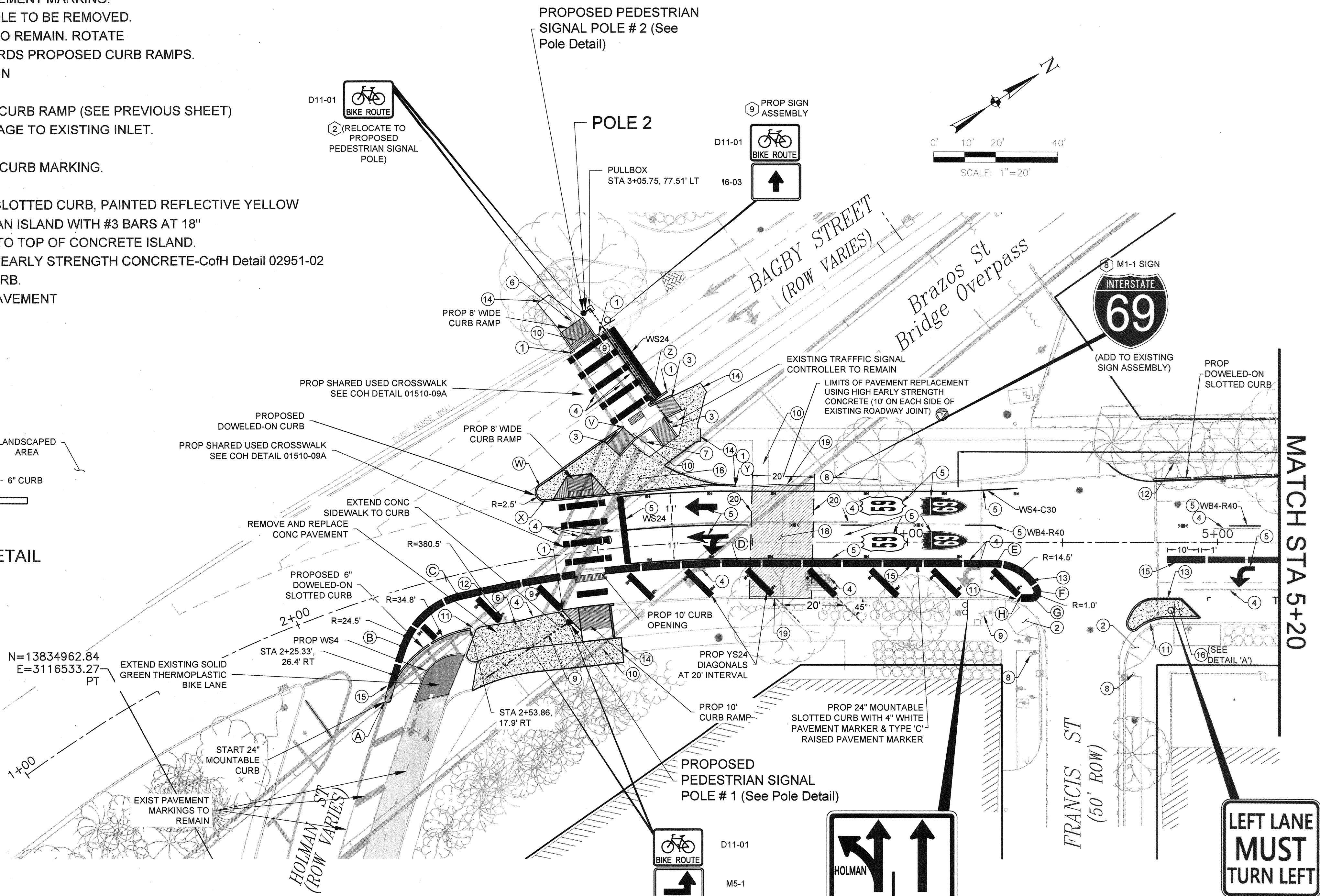

DETAIL 'A' (1"=5')

(1) (RELOCATE TO PROPOSED PEDESTRIAN SIGNAL POLE)

ABBREVIATION FOR PROPOSED THERMOPLASTIC PAVEMENT MARKERS
WB4-R40: 4" WIDE BROKEN WHITE PAVEMENT MARKING (10' STRIPE WITH 30' GAP) WITH COH TYPE 'R' RRPM (AT 40' INTERVAL)
WS4-C-30: 4" SOLID WHITE PAVEMENT MARKING WITH COH TYPE 'C' RRPM (AT 30' INTERVAL)
WS6-R-40: 6" SOLID WHITE PAVEMENT MARKING WITH COH TYPE 'R' RRPM (AT 40' INTERVAL)
YSX: X" WIDE SOLID YELLOW PAVEMENT MARKER
WSX: X" WIDE SOLID WHITE PAVEMENT MARKER

CONSTRUCTION POINTS

| Point | Station | Offset (Ft.) | SIDE | Description |
|-------|---------|--------------|------|-------------|
| A | 2+18.42 | 33.1 | RT | START CURB |
| B | 2+31.36 | 18.7 | RT | PC BOC |
| C | 2+53.02 | 8.0 | RT | PCC BOC |
| D | 3+45.63 | 8.0 | RT | PT BOC |
| E | 4+27.96 | 8.0 | RT | PC BOC |
| F | 4+40.78 | 15.7 | RT | PCC BOC |
| G | 4+39.89 | 17.2 | RT | PT BOC |
| H | 4+36.69 | 17.2 | RT | BOC |
| I | 4+71.10 | 25.7 | RT | PC BOC |
| J | 4+72.91 | 22.1 | RT | PCC BOC |
| K | 4+79.51 | 18.6 | RT | PT BOC |
| L | 4+88.08 | 18.6 | RT | BOC |
| M | 4+93.59 | 24.1 | RT | BOC |
| N | 4+83.85 | 24.1 | RT | PC BOC |
| O | 4+73.65 | 28.1 | RT | PCC BOC |
| P | 6+74.80 | 23.8 | RT | BOC |
| Q | 6+74.77 | 20.2 | RT | PC BOC |
| R | 6+76.77 | 18.2 | RT | PCC BOC |
| S | 6+84.54 | 22.7 | RT | PT BOC |
| T | 6+86.85 | 27.3 | RT | PC BOC |
| U | 6+80.00 | 24.4 | RT | PT BOC |
| V | 3+11.70 | 38.4 | LT | BOC |
| W | 2+84.84 | 23.2 | LT | PC BOC |
| X | 2+85.73 | 18.4 | LT | PT BOC |
| Y | 3+44.58 | 18.5 | LT | BOC |
| Z | 3+20.00 | 45.0 | LT | MATCH BOC |

NOTE:
ALL STANDARD AND CUSTOM PROPOSED SIGNS TO BE CONSTRUCTED USING DETAILS PROVIDED IN 'STANDARD HIGHWAY SIGN DESIGN FOR TEXAS'.

AGUIRRE & FIELDS
ENGINEERING INNOVATORS
TBP FIRM REGISTRATION # 739

AMANI ENGINEERING, INC.
8303 SOUTHWEST FREEWAY
SUITE 800
HOUSTON, TEXAS 77074
TEL: (713) 270-5700
TBP REG. NO.: F-4528
TBP REG. NO.: 100282-00

SURVEYED BY:
AMANI ENGINEERING, INC.
FIELD BOOK NO. P-6115

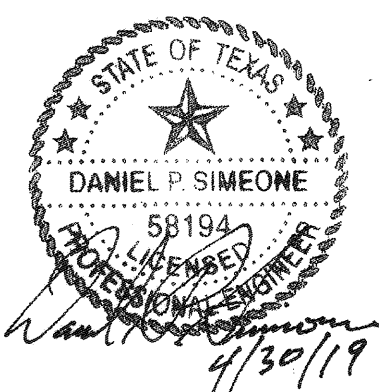

CITY OF HOUSTON
HOUSTON PUBLIC WORKS

**BRAZOS BRIDGE OVER SMITH ST.
AND HOLMAN ST. (DECK SLAB REPL)**

SMITH STREET IMPROVEMENTS

**SITE PLAN
(SHEET 1 OF 2)**

WBS NUMBER

N-320445-0006-4

DRAWING SCALE

1"=20'

CITY OF HOUSTON PM

SUDARSHAN GOUNI, PE

SHEET NO. 33 OF 107

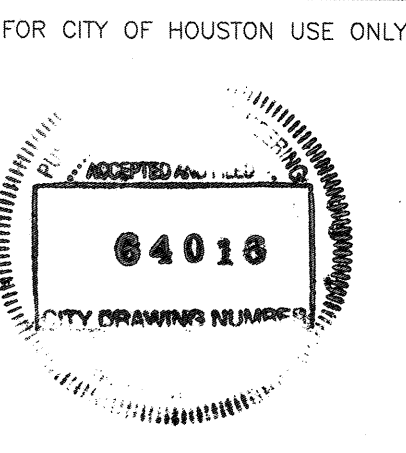

- 1 MATCH EXIST CURB.
- 2 EXIST CURB RAMP TO BE REMAIN.
- 3 PROPOSED 5' WIDE CURB RAMP.
- 4 REMOVE EXISTING THERMOPLASTIC PAVEMENT MARKING.
- 5 PROPOSED THERMOPLASTIC PAVEMENT MARKING.
- 6 EXISTING PEDESTRIAN SIGNAL POLE TO BE REMOVED.
- 7 EXISTING TRAFFIC SIGNAL POLE TO REMAIN. ROTATE PEDESTRIAN SIGNAL HEAD TOWARDS PROPOSED CURB RAMPS.
- 8 EXISTING TRAFFIC SIGN TO REMAIN
- 9 REMOVE EXISTING TRAFFIC SIGN
- 10 REMOVE EXISTING SIDEWALK OR CURB RAMP (SEE PREVIOUS SHEET)
- 11 18" CLEARANCE TO ALLOW DRAINAGE TO EXISTING INLET.
- 12 EXISTING INLET TO REMAIN
- 13 PROPOSED REFLECTIVE YELLOW CURB MARKING.
- 14 MATCH EXISTING SIDEWALK.
- 15 PROPOSED 2' WIDE MOUNTABLE SLOTTED CURB, PAINTED REFLECTIVE YELLOW
- 16 PROPOSED 6" REINFORCED MEDIAN ISLAND WITH #3 BARS AT 18"
- 17 ADJUST EXISTING WATER VALVE TO TOP OF CONCRETE ISLAND.
- 18 REPLACE PAVEMENT USING HIGH EARLY STRENGTH CONCRETE-CofH Detail 02951-02
- 19 REMOVE & REPLACE EXISTING CURB.

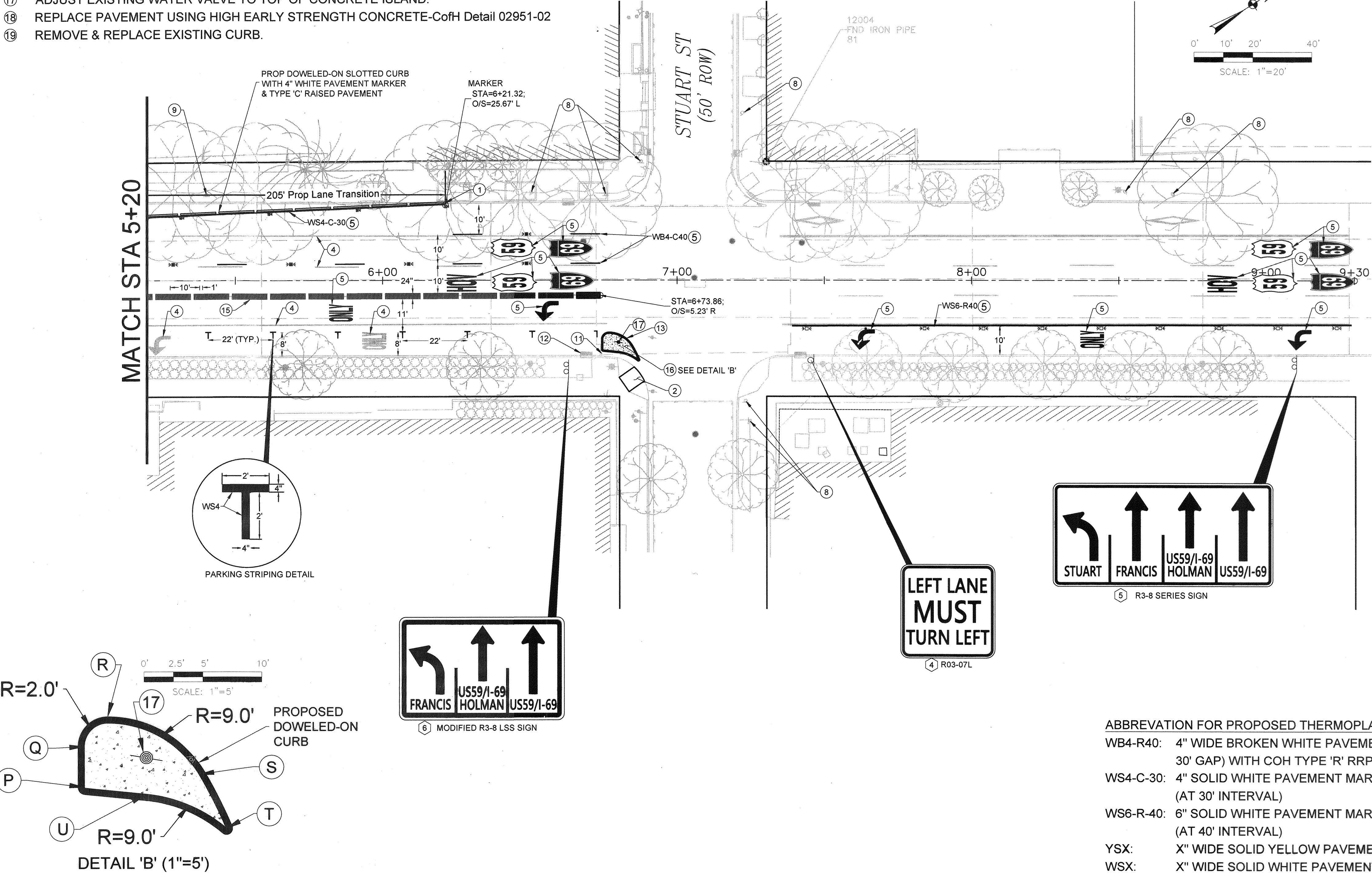

| CONSTRUCTION POINTS | | | | |
|---------------------|---------|--------------|------|-------------|
| Point | Station | Offset (Ft.) | SIDE | Description |
| A | 2+18.42 | 33.1 | RT | START CURB |
| B | 2+31.36 | 18.7 | RT | PC BOC |
| C | 2+53.02 | 8.0 | RT | PCC BOC |
| D | 3+45.63 | 8.0 | RT | PT BOC |
| E | 4+27.96 | 8.0 | RT | PC BOC |
| F | 4+40.78 | 15.7 | RT | PCC BOC |
| G | 4+39.89 | 17.2 | RT | PT BOC |
| H | 4+36.69 | 17.2 | RT | BOC |
| I | 4+71.10 | 25.7 | RT | PC BOC |
| J | 4+72.91 | 22.1 | RT | PCC BOC |
| K | 4+79.51 | 18.6 | RT | PT BOC |
| L | 4+88.08 | 18.6 | RT | BOC |
| M | 4+93.59 | 24.1 | RT | BOC |
| N | 4+83.85 | 24.1 | RT | PC BOC |
| O | 4+73.65 | 28.1 | RT | PCC BOC |
| P | 6+74.80 | 23.8 | RT | BOC |
| Q | 6+74.77 | 20.2 | RT | PC BOC |
| R | 6+76.77 | 18.2 | RT | PCC BOC |
| S | 6+84.54 | 22.7 | RT | PT BOC |
| T | 6+86.85 | 27.3 | RT | PC BOC |
| U | 6+80.00 | 24.4 | RT | PT BOC |
| V | 3+11.70 | 38.4 | LT | BOC |
| W | 2+84.84 | 23.2 | LT | PC BOC |
| X | 2+85.73 | 18.4 | LT | PT BOC |
| Y | 3+44.58 | 18.5 | LT | BOC |
| Z | 3+20.00 | 45.0 | LT | MATCH BOC |

NOTE:
ALL STANDARD AND CUSTOM PROPOSED
SIGNS TO BE CONSTRUCTED USING
DETAILS PROVIDED IN 'STANDARD
HIGHWAY SIGN DESIGN FOR TEXAS'.



AMANI
ENGINEERING, INC.
8303 SOUTHWEST FREEWAY
SUITE 600
HOUSTON, TEXAS 77074
TEL: (713) 270-5700
TBPE REG. NO.: F-4528
TBPLS REG. NO.: 100282-00

SURVEYED BY:
AMANI ENGINEERING, INC.
FIELD BOOK NO. P-6115

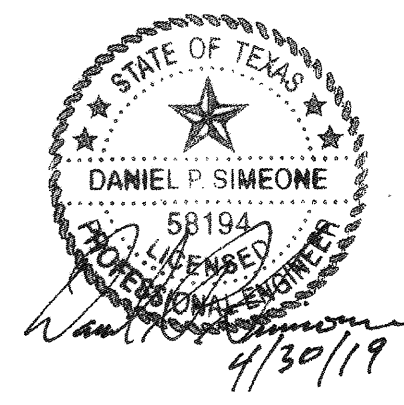

CITY OF HOUSTON
HOUSTON PUBLIC WORKS

BRAZOS BRIDGE OVER SMITH ST.
AND HOLMAN ST. (DECK SLAB REPL)

SMITH STREET IMPROVEMENTS

SITE PLAN
(SHEET 2 OF 2)

| WBS NUMBER | FOR CITY OF HOUSTON USE ONLY |
|---------------------|------------------------------|
| N-320445-0006-4 | |
| DRAWING SCALE | |
| 1"=20' | |
| CITY OF HOUSTON PM | |
| SUDARSHAN GOUNI, PE | |
| SHEET NO. 34 OF 107 | |

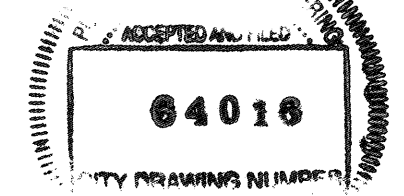

ABBREVIATION FOR PROPOSED THERMOPLASTIC PAVEMENT MARKERS
WB4-R40: 4" WIDE BROKEN WHITE PAVEMENT MARKING (10' STRIPE WITH 30" GAP) WITH COH TYPE 'R' RRPM (AT 40' INTERVAL)
WS4-C-30: 4" SOLID WHITE PAVEMENT MARKING WITH COH TYPE 'C' RRPM (AT 30' INTERVAL)
WS6-R40: 6" SOLID WHITE PAVEMENT MARKING WITH COH TYPE 'R' RRPM (AT 40' INTERVAL)
YSX: X" WIDE SOLID YELLOW PAVEMENT MARKER
WSX: X" WIDE SOLID WHITE PAVEMENT MARKER